

## WELDING BOSS

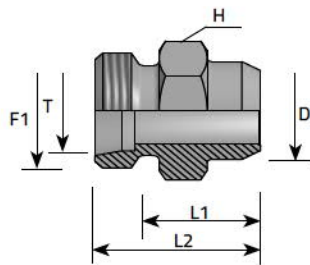

ADATTATORE DIRITTO MASCHIO DIN ESTREMITÀ A SALDARE  
 UNION SIMPLE À SOUDER  
 GERADE ANSCHWEISSVERSCHRAUBUNG – METRISCH 24°  
 RACOR RECTO PARA SOLDAR

F1 Metrisch, Metrico, Metric, Métrique, Métrico

| Code      | Thread | Dimensions |    |      |    |    | Pressure |      | Series |
|-----------|--------|------------|----|------|----|----|----------|------|--------|
|           |        | T1         | H  | L1   | L2 | D  | Bar      | Psi  |        |
|           | F1     | mm         | mm | mm   | mm | mm |          |      |        |
| AME06LW.1 | 12X1,5 | 6          | 12 | 14   | 21 | 10 | 315      | 4568 | L      |
| AME08LW.1 | 14X1,5 | 8          | 14 | 16   | 23 | 12 | 315      | 4568 | L      |
| AME10LW.1 | 16X1,5 | 10         | 17 | 18   | 25 | 14 | 315      | 4568 | L      |
| AME12LW.1 | 18X1,5 | 12         | 19 | 18   | 25 | 16 | 315      | 4568 | L      |
| AME15LW.1 | 22X1,5 | 15         | 22 | 22   | 29 | 19 | 315      | 4568 | L      |
| AME18LW.1 | 26X1,5 | 18         | 27 | 23,5 | 31 | 22 | 315      | 4568 | L      |
| AME22LW.1 | 30X2   | 22         | 32 | 28,5 | 36 | 27 | 160      | 2320 | L      |
| AME28LW.1 | 36X2   | 28         | 41 | 30,5 | 38 | 32 | 160      | 2320 | L      |
| AME35LW.1 | 45X2   | 35         | 46 | 32,5 | 43 | 40 | 160      | 2320 | L      |
| AME42LW.1 | 52X2   | 42         | 55 | 35   | 46 | 46 | 160      | 2320 | L      |
| AME06SW.1 | 14X1,5 | 6          | 14 | 19   | 26 | 11 | 630      | 9137 | S      |
| AME08SW.1 | 16X1,5 | 8          | 17 | 21   | 28 | 13 | 630      | 9137 | S      |
| AME10SW.1 | 18X1,5 | 10         | 19 | 22,5 | 30 | 15 | 630      | 9137 | S      |
| AME12SW.1 | 20X1,5 | 12         | 22 | 24,5 | 32 | 17 | 630      | 9137 | S      |
| AME14SW.1 | 22X1,5 | 14         | 24 | 27   | 35 | 19 | 630      | 9137 | S      |
| AME16SW.1 | 24X1,5 | 16         | 27 | 26,5 | 35 | 21 | 400      | 5801 | S      |
| AME20SW.1 | 30X2   | 20         | 32 | 29,5 | 40 | 26 | 400      | 5801 | S      |
| AME25SW.1 | 36X2   | 25         | 41 | 32   | 44 | 31 | 400      | 5801 | S      |
| AME30SW.1 | 42X2   | 30         | 46 | 35,5 | 49 | 36 | 400      | 5801 | S      |
| AME38SW.1 | 52X2   | 38         | 55 | 38   | 54 | 44 | 315      | 4568 | S      |