

Industrial Quick Connect Couplings

Series ESI single shut-off

DN 7.8

Plug Profile (original size)

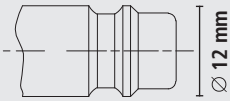

Also in Stainless Steel
Series ESIE
Page 301

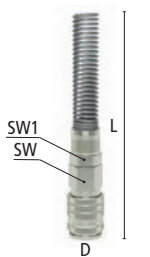
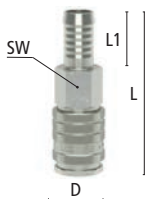
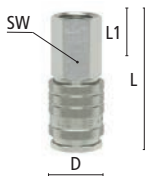
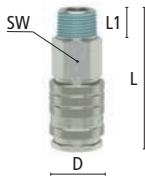

- Top-quality, extreme robust one-hand quick connect couplings with high-class sealing made of brass MS 58 nickel-plated
- Collar version: protection for valve body
- High flow rates with low pressure drop due to patented OptiFlow by **LUDECKE**® valve technology
- Suitable for low vacuum at low couple force compared to all other compatible products
- For compressed air supply in industry and handcrafts, we recommend direct use at tool
- Also interchangeable with plug profile ES DN 7.2

Materials

- Body, valve body: Brass MS 58 nickel-plated
- Valve: Brass MS 58 plain
- Sleeve, plug: Hardened steel nickel-plated
- Seals: NBR (other sealing materials on request)
- Springs: Stainless steel 1.4310
- Balls: Stainless steel 1.4034

Max. Working Pressure	Temperature	DN	Thread	Flow Rate	Operation	Type of Valve	Media	Area	⊕
PN 35 bar	-20°C – +100°C	7.8	ISO 228/DIN EN 10226	2000 l/min	One-hand	Single shut-off	Air/Others	Europe	Coupl. 5 / Plug 10

Couplings with tapered male thread (thread coated)

Thread connection	L	SW	D	L1	Weight	Type No.
R 1/4 m	60	19	24	11	98	ESI 14 A
R 3/8 m	61	19	24	12	97	ESI 38 A
R 1/2 m	64	22	24	15	114	ESI 12 A

Couplings with parallel female thread

Thread connection	L	SW	D	L1	Weight	Type No.
G 1/4 f	56	19	24	10	116	ESI 14 I
G 3/8 f	56	19	24	10	107	ESI 38 I
G 1/2 f	58	24	24	12	125	ESI 12 I

Couplings with hose barb

Hose connection	L	SW	D	L1	Weight	Type No.
Hose i.D. 6	73	19	24	25	95	ESI 6 T
Hose i.D. 8	73	19	24	25	97	ESI 8 T
Hose i.D. 9	73	19	24	25	98	ESI 9 T
Hose i.D. 10	73	19	24	25	97	ESI 10 T
Hose i.D. 13	73	19	24	25	101	ESI 13 T

For hose clips type ZOS (⊕ page 130), type HS (⊕ page 131) or crimping ferrules type LPH (⊕ page 133)

Couplings with squeeze nut

Hose connection	L	SW	D	SW1	Weight	Type No.
Hose 5x8	64	19	24	14	110	ESI 58 TQ
Hose 6x8	64	19	24	14	110	ESI 6 TQ
Hose 6.5x10	69	19	24	17	126	ESI 6510 TQ
Hose 8x10	69	19	24	19	134	ESI 8 TQ
Hose 8x12	68	19	24	19	129	ESI 812 TQ
Hose 9x13	70	19	24	19	130	ESI 913 TQ

Couplings with squeeze nut and spring guard

Hose connection	L	SW	D	SW1	Weight	Type No.
Hose 5x8	150	19	24	14	124	ESI 58 TQF
Hose 6x8	150	19	24	14	123	ESI 6 TQF
Hose 6.5x10	170	19	24	17	152	ESI 6510 TQF
Hose 8x10	170	19	24	19	162	ESI 8 TQF
Hose 8x12	144	19	24	19	156	ESI 812 TQF
Hose 9x13	170	19	24	19	162	ESI 913 TQF

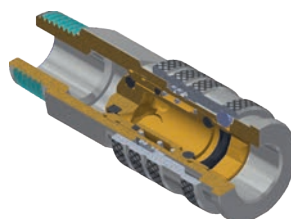

Industrial Quick Connect Couplings

single shut-off **Series ESI**

DN 7.8

Plug Profile (original size)

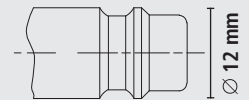

Plugs with tapered male thread (thread coated)

Thread connection	L	SW	L1	L2	Weight	Type No.
R 1/8 m	33	13	9	20	14	ESI 18 NARS
R 1/4 m	35	14	11	20	18	ESI 14 NARS
R 3/8 m	36	17	12	20	23	ESI 38 NARS
R 1/2 m	40	22	15	20	47	ESI 12 NARS

Plugs with parallel male thread

Thread connection	L	SW	L1	L2	Weight	Type No.
G 1/8 m	33	13	9	20	14	ESI 18 NAS
G 1/4 m	35	14	11	20	18	ESI 14 NAS
G 3/8 m	36	17	12	20	23	ESI 38 NAS
G 1/2 m	40	22	15	20	47	ESI 12 NAS

Plugs with parallel female thread

Thread connection	L	SW	L1	L2	Weight	Type No.
G 1/8 f	32	13	9	20	16	ESI 18 NIS
G 1/4 f	33	17	10	20	24	ESI 14 NIS
G 3/8 f	33	19	10	20	25	ESI 38 NIS
G 1/2 f	35	24	12	20	40	ESI 12 NIS

Plugs with hose barb

Hose connection	L	D	L1	L2	Weight	Type No.
Hose i.D. 6	44	12	24	20	13	ESI 6 SS
Hose i.D. 8	44	12	24	20	18	ESI 8 SS
Hose i.D. 9	44	12	24	20	16	ESI 9 SS
Hose i.D. 10	44	12	24	20	18	ESI 10 SS
Hose i.D. 13	44	15	23	20	26	ESI 13 SS

For hose clips type ZOS (© page 130), type HS (© page 131) or crimping ferrules type LPH (© page 133)

Plugs with squeeze nut

Hose connection	L	SW	L1	SW1	Weight	Type No.
Hose 5x8	40	14	20	14	29	ESI 58 SQ
Hose 6x8	40	14	20	14	29	ESI 6 SQ
Hose 6.5x10	44	17	20	17	45	ESI 6510 SQ
Hose 8x10	44	19	20	19	55	ESI 8 SQ
Hose 8x12	46	19	20	19	57	ESI 812 SQ
Hose 9x13	44	19	20	19	50	ESI 913 SQ

Plugs with squeeze nut and spring guard

Hose connection	L	SW	L1	SW1	Weight	Type No.
Hose 5x8	126	14	20	14	42	ESI 58 SQF
Hose 6x8	127	14	20	14	42	ESI 6 SQF
Hose 6.5x10	145	17	20	17	71	ESI 6510 SQF
Hose 8x10	121	19	20	19	79	ESI 8 SQF
Hose 8x12	123	19	20	19	84	ESI 812 SQF
Hose 9x13	146	19	20	19	83	ESI 913 SQF

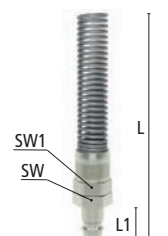
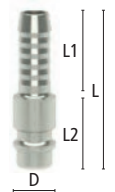
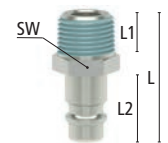

Opti
Flow
by LUDECKE

