

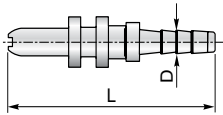

**Innesto per minipressa a baionetta**

Plug-in connection



Tubo / Hose	L	D	Codice/Ref.
<b>RD2*</b>	27	2.0	<b>33TD0000</b>
<b>RD3</b>	31	3.0	<b>33TD0003</b>
<b>RD4</b>	31	4.0	<b>33TD0004</b>

\*Disponibili in INOX /  
Available in Stainless steel

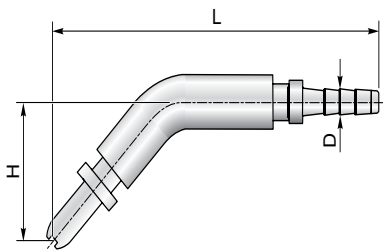

45°				
Tubo / Hose	H	L	D	Codice/Ref.
<b>RD2</b>	24	57	2.0	<b>33TD0040</b>
<b>RD3</b>	24	59	3.0	<b>33TD0043</b>
<b>RD4</b>	24	59	4.0	<b>33TD0044</b>

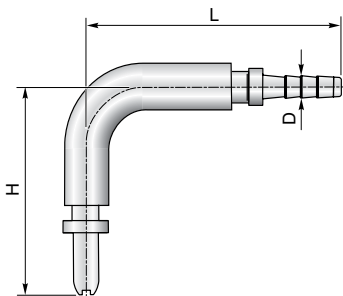

90°				
Tubo / Hose	H	L	D	Codice/Ref.
<b>RD2</b>	28	32	2.0	<b>33TD0090</b>
<b>RD3</b>	28	36	3.0	<b>33TD0093</b>
<b>RD4</b>	28	36	4.0	<b>33TD0094</b>

**Ghiera a pressare**

Ferrule

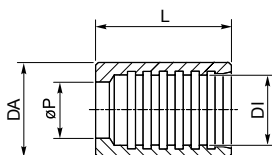

DA	DI	L	ØP	Ø Press	PN [bar]	Codice/Ref.
8.0*	5.1	15	4.5	7.1	600	<b>30BT2000</b>
9.0*	6.5	17	6	7.6	600	<b>30BT3000</b>
12*	9.2	17	6.5	10.2	600	<b>30BT4000</b>

\*Disponibili in INOX /  
Available in Stainless steel

Ø Press = Diametro di pressatura / Crimping diameters