

Plug-in connection

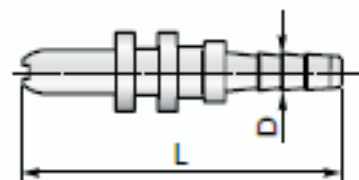

Tubo / Hose	L	D	Codice/Ref.
RD2*	27	2.0	33TD0000
RD3	31	3.0	33TD0003
RD4	31	4.0	33TD0004

*Disponibili in INOX /
Available in Stainless steel

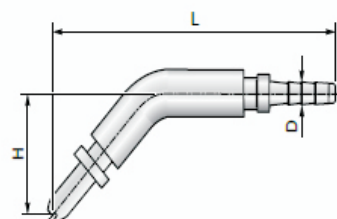

45°

DA	DI	L	ØP	Ø Press	PN [bar]	Codice/Ref.
8.0*	5.1	15	4.5	7.1	600	30BT2000
9.0*	6.5	17	6	7.6	600	30BT3000
12*	9.2	17	6.5	10.2	600	30BT4000

*Disponibili in INOX /
Available in Stainless steel

Ø Press = Diametro di pressatura / Crimping diameters

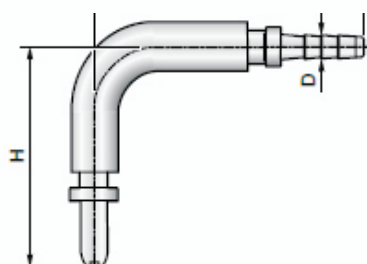

90°

Tubo / Hose	H	L	D	Codice/Ref.
RD2	28	32	2.0	33TD0090
RD3	28	36	3.0	33TD0093
RD4	28	36	4.0	33TD0094

Ferrule

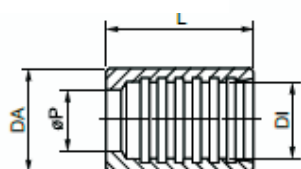

*Disponibili in INOX /
Available in Stainless steel

DA	DI	L	ØP	Ø Press	PN [bar]	Codice/Ref.
8.0*	5.1	15	4.5	7.1	600	30BT2000
9.0*	6.5	17	6	7.6	600	30BT3000
12*	9.2	17	6.5	10.2	600	30BT4000

Ø Press = Diametro di pressatura / Crimping diameters