

PPV3



| Nominal size | | | | Max working pressure | Rated flow | Max flow rate | Min burst pressure | | | Fluid spillage |
|--------------|----|------|------|----------------------|------------|---------------|--------------------|--------|---------|----------------|
| | | | | | | | Male | Female | Coupled | |
| DNP | BG | ISO | mm | Mpa | l/min | l/min | MPa | MPa | MPa | cc |
| 06 | 1 | 6.3 | 5 | 35 | 12 | 17 | 180 | 140 | 140 | 0,5 |
| 10 | 2 | 10 | 8,5 | 30 | 23 | 46 | 130 | 150 | 130 | 1,9 |
| 13 | 3 | 12.5 | 10,5 | 23 | 45 | 90 | 93 | 160 | 110 | 2,7 |
| 20 | 4 | 19 | 15,7 | 25 | 106 | 190 | 120 | 140 | 110 | 9,3 |
| 25 | 5 | 25 | 17,3 | 22,5 | 189 | 280 | 90 | 110 | 97 | 16 |

Caratteristiche tecniche

- Norma: ISO 7241-1 A
- Ghiera: doppia azione
- Occlusione: valvola
- Aggancio: sfere radiali
- Materiale: acciaio
- Finitura: Zn-Fe (Cr III)
- Filettature: BSP – NPT – SAE – METRICHE
- Guarnizioni standard: NBR
- Temperatura d'esercizio: -25 °C +100 °C
- Guarnizioni opzionali: FKM, EPDM o altro
- Pressioni di esercizio: 225-350 bar
- Connessione in pressione: non consentita

Technical data

- Standard: ISO 7241-1 A
- Sleeve: double acting
- Occlusion: poppet
- Locking: radial balls
- Material: steel
- Finishing: Zn-Fe (Cr III)
- Threads: BSP – NPT – SAE – METRICS
- Standard seals: NBR
- Working temperature: -25 °C +100 °C
- Optional seals: FKM, EPDM or more
- Working pressure: 225-350 bar
- Connection under pressure: not allowed

Technische Merkmale

- Norm: ISO 7241-1 A
- Hülse: doppelwirkend
- Verschluss: ventil
- Kupplung: Radialkugeln
- Werkstoff: Stahl
- Ausführung: Zn-Fe (Cr III)
- Gewinde: BSP – NPT – SAE – METRISCHE
- Standard-Dichtungen: NBR
- Betriebstemperatur: -25 °C +100 °C
- Dichtungen nach Wahl: FKM, EPDM, usw.
- Betriebsdruck: 225-350 bar
- Kuppeln unter Druck: nicht möglich

Caracteristiques techniques

- Norme: ISO 7241-1 A
- Douille: double action
- Obturation: clapet
- Accrochage: billes radiales
- Matériel: acier
- Traitement: Zn-Fe (Cr III)
- Taraudage: BSP – NPT – SAE – METRIQUES
- Joints standard: NBR
- Température de service: -25 °C +100 °C
- Joints facultatifs: FKM, EPDM, ect.
- Pression de service: 225-350 bar
- Connexion sous pression: pas possible

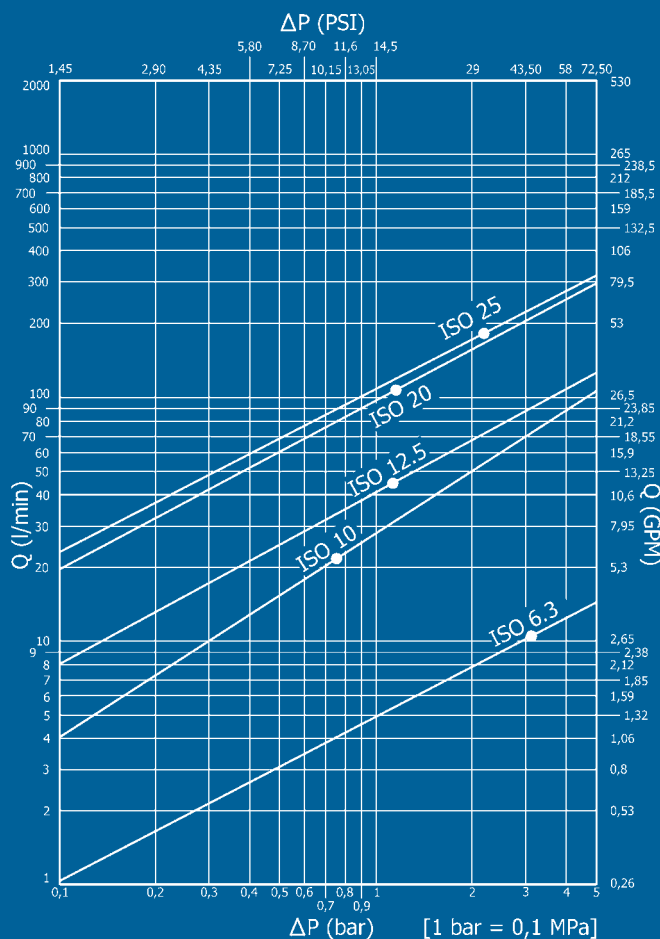

PPV3 DN06 - BG 1 - ISO 6.3

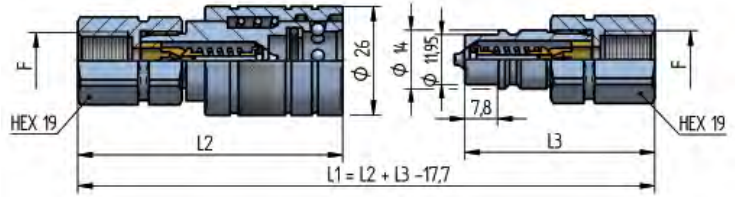

| THREADS | L2 | L3 | L4 | ØT | F | STANDARD | FEMMINA - FEMALE - MUFFE - FEMELLE | | | MASCHIO - MALE - STECKER - MALE | | |
|--------------|----|------|----|-----|----------|--------------|------------------------------------|------------|------------------|---------------------------------|------------|------------------|
| | | | | | | | COD. F | Weight (g) | Packaging (pcs.) | COD. M | Weight (g) | Packaging (pcs.) |
| IG 1 | 64 | 45,5 | | | BSP 1/4" | DIN 3852-2-X | PPV3.0606.112 | 137 | 180 | PPV3.0606.113 | 55 | 300 |
| | 64 | 45,5 | | | NPT 1/4" | ANSI B1.20.3 | PPV3.0606.012 | 138 | 180 | PPV3.0606.013 | 56 | 300 |
| AG 3 | 62 | 42 | 10 | Ø8L | M14x1,5 | ISO 8434-1-L | PPV3.0614.302 | 126 | 180 | PPV3.0614.303 | 43 | 300 |
| AGS 3 | 77 | 57 | 25 | Ø8L | M14x1,5 | ISO 8434-1-L | PPV3.0614.502 | 139 | 100 | PPV3.0614.503 | 56 | 200 |

PPV3 DN10 - BG 2 - ISO 10

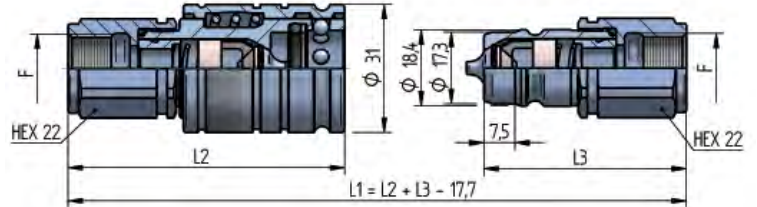

| THREADS | L2 | L3 | L4 | ØT | F | STANDARD | FEMMINA - FEMALE - MUFFE - FEMELLE | | | MASCHIO - MALE - STECKER - MALE | | |
|--------------|------|------|------|------|-----------------|--------------|------------------------------------|------------|------------------|---------------------------------|------------|------------------|
| | | | | | | | COD. F | Weight (g) | Packaging (pcs.) | COD. M | Weight (g) | Packaging (pcs.) |
| IG 1 | 67 | 49 | | | BSP 1/4" | DIN 3852-2-X | PPV3.1006.112 | 195 | 60 | PPV3.1006.113 | 82 | 150 |
| | 67 | 49 | | | NPT 1/4" | ANSI B1.20.3 | PPV3.1006.012 | 196 | 60 | PPV3.1006.013 | 83 | 150 |
| | 67 | 49 | | | BSP 3/8" | DIN 3852-2-X | PPV3.1010.112 | 186 | 60 | PPV3.1010.113 | 73 | 150 |
| | 67 | 49 | | | NPT 3/8" | ANSI B1.20.3 | PPV3.1010.012 | 188 | 60 | PPV3.1010.013 | 74 | 150 |
| | 67 | 49 | | | M16x1,5 | ISO 6149-1 | PPV3.1016.102 | 189 | 60 | PPV3.1016.103 | 75 | 150 |
| | 67 | 49 | | | M18x1,5 | ISO 6149-1 | PPV3.1018.102 | 182 | 60 | PPV3.1018.103 | 69 | 150 |
| IG 2 | 67 | 49 | | | 9/16"-18 UNF 2B | SAE J 1926-1 | PPV3.1015.032 | 192 | 60 | PPV3.1015.033 | 79 | 150 |
| AG 2 | 68,9 | 50,9 | 14,1 | | 9/16"-18 UNF 2A | SAE J 514 | PPV3.1015.302 | 180 | 60 | PPV3.1015.303 | 66 | 150 |
| AGS 2 | 88,1 | 70,1 | 33,3 | | 9/16"-18 UNF 2A | SAE J 514 | PPV3.1015.502 | 193 | 60 | PPV3.1015.503 | 79 | 120 |
| AG 5 | 69,3 | 51,3 | 12 | | BSP 3/8" | DIN 3852-2-B | PPV3.1010.212 | 188 | 60 | PPV3.1010.213 | 75 | 150 |
| | 68,8 | 50,8 | 12 | | BSP 1/4" | DIN 3852-2-A | PPV3.1006.712 | 183 | 60 | PPV3.1006.713 | 69 | 150 |
| | 69,3 | 51,3 | 12 | | BSP 3/8" | DIN 3852-2-A | PPV3.1010.712 | 188 | 60 | PPV3.1010.713 | 75 | 150 |
| AG 7 | 68,8 | 50,8 | 14 | | NPT 1/4" | ANSI B1.20.3 | PPV3.1006.022 | 182 | 60 | PPV3.1006.023 | 69 | 150 |
| | 68,8 | 50,8 | 14 | | R 1/4"-19 | UNI ISO 7/1 | PPV3.1006.042 | 182 | 60 | PPV3.1006.043 | 69 | 150 |
| AG 3 | 64,8 | 46,8 | 10 | Ø6L | M12x1,5 | ISO 8434-1-L | PPV3.1012.302 | 177 | 60 | PPV3.1012.303 | 64 | 150 |
| | 64,8 | 46,8 | 10 | Ø8L | M14x1,5 | ISO 8434-1-L | PPV3.1014.302 | 178 | 60 | PPV3.1014.303 | 65 | 150 |
| | 65,8 | 47,8 | 11 | Ø10L | M16x1,5 | ISO 8434-1-L | PPV3.1016.302 | 179 | 60 | PPV3.1016.303 | 66 | 150 |
| | 65,8 | 47,8 | 11 | Ø12L | M18x1,5 | ISO 8434-1-L | PPV3.1018.302 | 180 | 60 | PPV3.1018.303 | 66 | 150 |
| | 66,8 | 48,8 | 12 | Ø8S | M16x1,5 | ISO 8434-1-S | PPV3.1016.402 | 183 | 60 | PPV3.1016.403 | 70 | 150 |
| | 66,8 | 48,8 | 12 | Ø10S | M18x1,5 | ISO 8434-1-S | PPV3.1018.402 | 185 | 60 | PPV3.1018.403 | 72 | 150 |
| | 66,8 | 48,8 | 12 | Ø12S | M20x1,5 | ISO 8434-1-S | PPV3.1020.402 | 187 | 60 | PPV3.1020.403 | 74 | 150 |
| | 66,8 | 48,8 | 12 | Ø6L | M12x1,5 | ISO 8434-1-L | PPV3.1012.502 | 194 | 60 | PPV3.1012.503 | 81 | 120 |
| AGS 3 | 80,8 | 62,8 | 26 | Ø8L | M14x1,5 | ISO 8434-1-L | PPV3.1014.502 | 198 | 60 | PPV3.1014.503 | 85 | 120 |
| | 80,8 | 62,8 | 26 | Ø10L | M16x1,5 | ISO 8434-1-L | PPV3.1016.502 | 204 | 60 | PPV3.1016.503 | 90 | 120 |
| | 80,8 | 62,8 | 26 | Ø12L | M18x1,5 | ISO 8434-1-L | PPV3.1018.502 | 209 | 60 | PPV3.1018.503 | 95 | 120 |
| | 81,8 | 63,8 | 27 | Ø8S | M16x1,5 | ISO 8434-1-S | PPV3.1016.602 | 212 | 60 | PPV3.1016.603 | 99 | 120 |
| | 81,8 | 63,8 | 27 | Ø10S | M18x1,5 | ISO 8434-1-S | PPV3.1018.602 | 219 | 60 | PPV3.1018.603 | 105 | 120 |
| | 81,8 | 63,8 | 27 | Ø12S | M20x1,5 | ISO 8434-1-S | PPV3.1020.602 | 228 | 60 | PPV3.1020.603 | 115 | 120 |

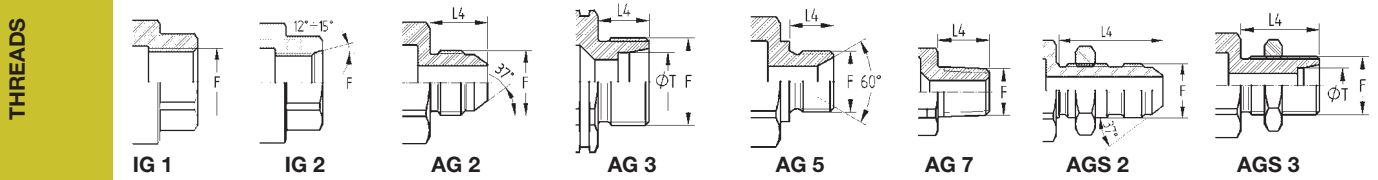

PPV3 DN13 - BG 3 - ISO 12.5

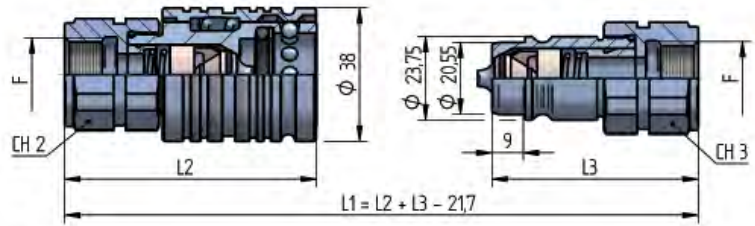

| THREADS | CH 2 | L 2 | CH 3 | L 3 | L 4 | Ø T | F | STANDARD | FEMMINA - FEMALE - MUFFE - FEMELLE | | | MASCIO - MALE - STECKER - MALE | | |
|--------------|--------------|-------|------|------|------|-----|-----------------|--------------|------------------------------------|---------------|------------------|--------------------------------|---------------|------------------|
| | | | | | | | | | COD. F | Weight (g) | Packaging (pcs.) | COD. M | Weight (g) | Packaging (pcs.) |
| IG 1 | 30 | 72 | 30 | 59 | | | BSP 3/8" | DIN 3852-2-X | PPV3.1310.112 | 324 | 35 | PPV3.1310.113 | 166 | 60 |
| | 30 | 74,5 | 30 | 61,5 | | | NPT 3/8" | ANSI B1.20.3 | PPV3.1310.012 | 350 | 35 | PPV3.1310.013 | 192 | 60 |
| | 30 | 72 | 30 | 59 | | | BSP 1/2" | DIN 3852-2-X | PPV3.1313.112 | 320 | 35 | PPV3.1313.113 | 162 | 60 |
| | 30 | 75 | 30 | 62 | | | NPT 1/2" | ANSI B1.20.3 | PPV3.1313.012 | 334 | 35 | PPV3.1313.013 | 176 | 60 |
| | 36 | 77,5 | 36 | 64,5 | | | BSP 3/4" | DIN 3852-2-X | PPV3.1319.112 | 373 | 35 | PPV3.1319.113 | 215 | 40 |
| | 36 | 77,5 | 36 | 64,5 | | | NPT 3/4" | ANSI B1.20.3 | PPV3.1319.012 | 382 | 35 | PPV3.1319.013 | 224 | 40 |
| | 30 | 72 | 30 | 59 | | | M14x1,5 | ISO 6149-1 | PPV3.1314.102 | 333 | 35 | PPV3.1314.103 | 175 | 60 |
| | 30 | 72 | 30 | 59 | | | M16x1,5 | ISO 6149-1 | PPV3.1316.102 | 327 | 35 | PPV3.1316.103 | 169 | 60 |
| | 30 | 72 | 30 | 59 | | | M18x1,5 | ISO 6149-1 | PPV3.1318.102 | 321 | 35 | PPV3.1318.103 | 163 | 60 |
| | 30 | 72 | 30 | 59 | | | M20x1,5 | ISO 6149-1 | PPV3.1320.102 | 324 | 35 | PPV3.1320.103 | 166 | 60 |
| IG 2 | 30 | 72 | 30 | 59 | | | 9/16"-18 UNF 2B | SAE J 1926-1 | PPV3.1315.032 | 331 | 35 | PPV3.1315.033 | 173 | 60 |
| | 30 | 72 | 30 | 59 | | | 3/4"-16 UNF 2B | SAE J 1926-1 | PPV3.1319.032 | 326 | 35 | PPV3.1319.033 | 168 | 60 |
| | 30 | 76 | 30 | 63 | | | 7/8"-14 UNF 2A | SAE J 1926-1 | PPV3.1323.032 | 325 | 35 | PPV3.1323.033 | 167 | 60 |
| | 30 | 74 | 30 | 61 | | | M16x1,5 | SAE J 2244/1 | PPV3.1316.112 | 341 | 35 | PPV3.1316.113 | 183 | 60 |
| | 30 | 72 | 30 | 59 | | | M22x1,5 | SAE J 2244/1 | PPV3.1322.102 | 313 | 35 | PPV3.1322.103 | 155 | 60 |
| AG 1 | 27 | 72,1 | 27 | 59,1 | 11,1 | | 3/4"-16 UNF 2A | SAE J 1926-3 | PPV3.1319.332 | 292 | 35 | PPV3.1319.333 | 134 | 70 |
| | 30 | 75 | 30 | 62 | 16 | | M20x1,5 | ISO 6149-2 | PPV3.1320.222 | 311 | 35 | PPV3.1320.223 | 153 | 60 |
| AG 2 | 30 | 75,7 | 30 | 62,7 | 16,7 | | 3/4"-16 UNF 2A | SAE J 514 | PPV3.1319.302 | 301 | 35 | PPV3.1319.303 | 143 | 60 |
| AGS 2 | 30 | 96,6 | 30 | 83,6 | 37,6 | | 3/4"-16 UNF 2A | SAE J 514 | PPV3.1319.502 | 328 | 35 | PPV3.1319.503 | 170 | 60 |
| | 30 | 100,1 | 30 | 87,1 | 41,1 | | 7/8"-14 UNF 2A | SAE J 514 | PPV3.1323.502 | 344 | 35 | PPV3.1323.503 | 186 | 60 |
| AG 5 | 30 | 73,5 | 30 | 60,5 | 12 | | BSP 3/8" | DIN 3852-2-B | PPV3.1310.212 | 302 | 35 | PPV3.1310.213 | 144 | 60 |
| | 30 | 76 | 30 | 63 | 13 | | BSP 1/2" | DIN 3852-2-B | PPV3.1313.212 | 310 | 35 | PPV3.1313.213 | 152 | 60 |
| | 30 | 70 | 30 | 57 | 11 | | M16x1,5 | DIN 3863-U | PPV3.1316.702 | 294 | 35 | PPV3.1316.703 | 136 | 60 |
| | 30 | 75 | 30 | 62 | 16 | | M20x1,5 | DIN 3863-U | PPV3.1320.702 | 307 | 35 | PPV3.1320.703 | 148 | 60 |
| | 30 | 73 | 30 | 60 | 14 | | M22x1,5 | DIN 3863-U | PPV3.1322.702 | 304 | 35 | PPV3.1322.703 | 146 | 60 |
| AG 3 | 30 | 69 | 30 | 56 | 10 | 08L | M14x1,5 | ISO 8434-1-L | PPV3.1314.302 | 292 | 35 | PPV3.1314.303 | 134 | 60 |
| | 30 | 70 | 30 | 57 | 11 | 10L | M16x1,5 | ISO 8434-1-L | PPV3.1316.302 | 293 | 35 | PPV3.1316.303 | 135 | 60 |
| | 30 | 70 | 30 | 57 | 11 | 12L | M18x1,5 | ISO 8434-1-L | PPV3.1318.302 | 294 | 35 | PPV3.1318.303 | 136 | 60 |
| | 30 | 71 | 30 | 58 | 12 | 15L | M22x1,5 | ISO 8434-1-L | PPV3.1322.302 | 299 | 35 | PPV3.1322.303 | 141 | 60 |
| | 30 | 71 | 30 | 58 | 12 | 18L | M26x1,5 | ISO 8434-1-L | PPV3.1326.302 | 304 | 35 | PPV3.1326.303 | 146 | 60 |
| | 30 | 71 | 30 | 58 | 12 | 10S | M18x1,5 | ISO 8434-1-S | PPV3.1318.402 | 299 | 35 | PPV3.1318.403 | 141 | 60 |
| | 30 | 71 | 30 | 58 | 12 | 12S | M20x1,5 | ISO 8434-1-S | PPV3.1320.402 | 301 | 35 | PPV3.1320.403 | 143 | 60 |
| | 30 | 73 | 30 | 60 | 14 | 14S | M22x1,5 | ISO 8434-1-S | PPV3.1322.402 | 306 | 35 | PPV3.1322.403 | 148 | 60 |
| | 30 | 73 | 30 | 60 | 14 | 16S | M24x1,5 | ISO 8434-1-S | PPV3.1324.402 | 307 | 35 | PPV3.1324.403 | 149 | 60 |
| | 30 | 75 | 30 | 62 | 16 | 20S | M30x2 | ISO 8434-1-S | PPV3.1330.402 | 323 | 35 | PPV3.1330.403 | 165 | 60 |
| | 27 | 70 | 27 | 57 | 11 | 12L | M18x1,5 | ISO 8434-1-L | PPV5.1318.302 | 281 | 35 | PPV5.1318.303 | 123 | 70 |
| | AGS 3 | 30 | 85 | 30 | 72 | 26 | 08L | M14x1,5 | ISO 8434-1-L | PPV3.1314.502 | 312 | 35 | PPV3.1314.503 | 154 |
| 30 | | 85 | 30 | 72 | 26 | 10L | M16x1,5 | ISO 8434-1-L | PPV3.1316.502 | 318 | 35 | PPV3.1316.503 | 160 | 60 |
| 30 | | 85 | 30 | 72 | 26 | 12L | M18x1,5 | ISO 8434-1-L | PPV3.1318.502 | 322 | 35 | PPV3.1318.503 | 164 | 60 |
| 30 | | 95 | 30 | 82 | 36 | 12L | M18x1,5 | ISO 8434-1-L | PPV3.1318.512 | 330 | 35 | PPV3.1318.513 | 172 | 60 |
| 30 | | 86 | 30 | 73 | 27 | 15L | M22x1,5 | ISO 8434-1-L | PPV3.1322.502 | 347 | 35 | PPV3.1322.503 | 189 | 60 |
| 30 | | 86 | 30 | 73 | 27 | 18L | M26x1,5 | ISO 8434-1-L | PPV3.1326.502 | 378 | 35 | PPV3.1326.503 | 220 | 60 |
| 30 | | 86 | 30 | 73 | 27 | 10S | M18x1,5 | ISO 8434-1-S | PPV3.1318.602 | 333 | 35 | PPV3.1318.603 | 175 | 60 |
| 30 | | 86 | 30 | 73 | 27 | 12S | M20x1,5 | ISO 8434-1-S | PPV3.1320.602 | 341 | 35 | PPV3.1320.603 | 183 | 60 |
| 30 | | 88 | 30 | 75 | 29 | 14S | M22x1,5 | ISO 8434-1-S | PPV3.1322.602 | 360 | 35 | PPV3.1322.603 | 202 | 60 |
| 30 | | 88 | 30 | 75 | 29 | 16S | M24x1,5 | ISO 8434-1-S | PPV3.1324.602 | 365 | 35 | PPV3.1324.603 | 207 | 60 |
| 30 | | 88 | 30 | 75 | 29 | 20S | M30x2 | ISO 8434-1-S | PPV3.1330.602 | 419 | 35 | PPV3.1330.603 | 261 | 60 |
| 27 | | 85 | 27 | 72 | 26 | 12L | M18x1,5 | ISO 8434-1-L | PPV5.1318.502 | 309 | 35 | PPV5.1318.503 | 151 | 70 |
| 27 | | 86 | 27 | 73 | 27 | 15L | M22x1,5 | ISO 8434-1-L | PPV5.1322.502 | 335 | 35 | PPV5.1322.503 | 177 | 70 |

PPV3 DN20 - BG 4 - ISO 19

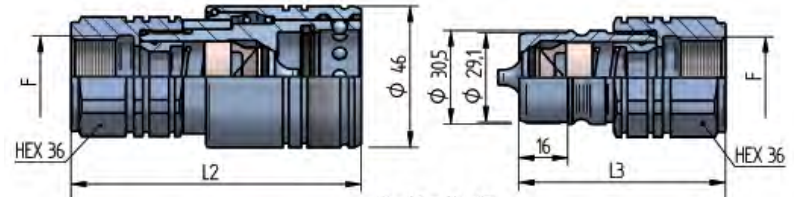

| THREADS | L2 | L3 | L4 | ØT | F | STANDARD | FEMMINA - FEMALE - MUFFE - FEMELLE | | | MASCHIO - MALE - STECKER - MALE | | |
|---------|-------|-------|------|-------|-----------------|---------------|------------------------------------|---------------|------------------|---------------------------------|---------------|------------------|
| | | | | | | | COD. F | Weight (g) | Packaging (pcs.) | COD. M | Weight (g) | Packaging (pcs.) |
| IG 1 | 92,8 | 65,5 | | | BSP 1/2" | DIN 3852-2-X | PPV3.2013.112 | 626 | 24 | PPV3.2013.113 | 291 | 42 |
| | 94,3 | 67 | | | NPT 1/2" | ANSI B1.20.3 | PPV3.2013.012 | 636 | 24 | PPV3.2013.013 | 301 | 42 |
| | 94,8 | 67,5 | | | BSP 3/4" | DIN 3852-2-X | PPV3.2019.112 | 603 | 24 | PPV3.2019.113 | 268 | 42 |
| | 94,3 | 67 | | | NPT 3/4" | ANSI B1.20.3 | PPV3.2019.012 | 611 | 24 | PPV3.2019.013 | 277 | 42 |
| | 90,8 | 63,5 | | | M18x1,5 | ISO 6149-1 | PPV3.2018.102 | 622 | 24 | PPV3.2018.103 | 287 | 42 |
| | 90,3 | 63 | | | M22x1,5 | ISO 6149-1 | PPV3.2022.102 | 605 | 24 | PPV3.2022.103 | 270 | 42 |
| | 94,3 | 67 | | | M26x1,5 | ISO 6149-1 | PPV3.2026.102 | 602 | 24 | PPV3.2026.103 | 267 | 42 |
| | 94,3 | 67 | | | M30x1,5 | ISO 6149-1 | PPV3.2030.102 | 575 | 24 | PPV3.2030.103 | 241 | 42 |
| IG 2 | 90,3 | 63 | | | 3/4"-16 UNF 2B | SAE J 1926-1 | PPV3.2019.032 | 615 | 24 | PPV3.2019.033 | 280 | 42 |
| | 94,3 | 67 | | | 7/8"-14 UNF 2B | SAE J 1926-1 | PPV3.2023.032 | 627 | 24 | PPV3.2023.033 | 292 | 42 |
| | 94,3 | 67 | | | 1"1/16-16 UN 2B | SAE J 1926-1 | PPV3.2027.032 | 597 | 24 | PPV3.2027.033 | 263 | 42 |
| AG 2 | 101,3 | 74 | 22 | | 1"1/16-16 UN 2A | SAE J 514 | PPV3.2027.302 | 575 | 24 | PPV3.2027.303 | 240 | 42 |
| AGS 2 | 120,4 | 93,1 | 41,1 | | 7/8"-14 UNF 2A | SAE J 514 | PPV3.2023.502 | 612 | 10 | PPV3.2023.503 | 278 | 30 |
| | 124,7 | 97,4 | 45,4 | | 1"1/16-16 UN 2A | SAE J 514 | PPV3.2027.502 | 645 | 10 | PPV3.2027.503 | 310 | 30 |
| AG 5 | 98,3 | 71 | 16 | | BSP 3/4" | DIN 3852-2-A | PPV3.2019.712 | 594 | 24 | PPV3.2019.713 | 260 | 42 |
| AG 3 | 90,3 | 63 | 11 | 12L | M18x1,5 | ISO 8434-1-L | PPV3.2018.302 | 561 | 24 | PPV3.2018.303 | 226 | 42 |
| | 91,3 | 64 | 12 | 15L | M22x1,5 | ISO 8434-1-L | PPV3.2022.302 | 565 | 24 | PPV3.2022.303 | 231 | 42 |
| | 91,3 | 64 | 12 | 18L | M26x1,5 | ISO 8434-1-L | PPV3.2026.302 | 572 | 24 | PPV3.2026.303 | 237 | 42 |
| | 93,3 | 66 | 14 | 22L | M30x2 | ISO 8434-1-L | PPV3.2030.302 | 575 | 24 | PPV3.2030.303 | 241 | 42 |
| | 91,3 | 64 | 12 | 10S | M18x1,5 | ISO 8434-1-S | PPV3.2018.402 | 564 | 24 | PPV3.2018.403 | 230 | 42 |
| | 91,3 | 64 | 12 | 12S | M20x1,5 | ISO 8434-1-S | PPV3.2020.402 | 567 | 24 | PPV3.2020.403 | 232 | 42 |
| | 93,3 | 66 | 14 | 14S | M22x1,5 | ISO 8434-1-S | PPV3.2022.402 | 571 | 24 | PPV3.2022.403 | 236 | 42 |
| | 93,3 | 66 | 14 | 16S | M24x1,5 | ISO 8434-1-S | PPV3.2024.402 | 574 | 24 | PPV3.2024.403 | 239 | 42 |
| | 95,3 | 68 | 16 | 20S | M30x2 | ISO 8434-1-S | PPV3.2030.402 | 588 | 24 | PPV3.2030.403 | 253 | 42 |
| | AGS 3 | 105,3 | 78 | 26 | 12L | M18x1,5 | ISO 8434-1-L | PPV3.2018.502 | 589 | 10 | PPV3.2018.503 | 254 |
| 106,3 | | 79 | 27 | 15L | M22x1,5 | ISO 8434-1-L | PPV3.2022.502 | 614 | 10 | PPV3.2022.503 | 279 | 30 |
| 106,3 | | 79 | 27 | 18L | M26x1,5 | ISO 8434-1-L | PPV3.2026.502 | 646 | 10 | PPV3.2026.503 | 311 | 30 |
| 113,3 | | 86 | 34 | 22L | M30x2 | ISO 8434-1-L | PPV3.2030.502 | 682 | 10 | PPV3.2030.503 | 348 | 30 |
| 106,3 | | 79 | 27 | 10S | M18x1,5 | ISO 8434-1-S | PPV3.2018.602 | 597 | 10 | PPV3.2018.603 | 262 | 30 |
| 106,3 | | 79 | 27 | 12S | M20x1,5 | ISO 8434-1-S | PPV3.2020.602 | 608 | 10 | PPV3.2020.603 | 273 | 30 |
| 108,3 | | 81 | 29 | 14S | M22x1,5 | ISO 8434-1-S | PPV3.2022.602 | 623 | 10 | PPV3.2022.603 | 289 | 30 |
| 108,3 | | 81 | 29 | 16S | M24x1,5 | ISO 8434-1-S | PPV3.2024.602 | 631 | 10 | PPV3.2024.603 | 296 | 30 |
| 113,3 | 86 | 34 | 20S | M30x2 | ISO 8434-1-S | PPV3.2030.602 | 677 | 10 | PPV3.2030.603 | 343 | 30 | |
| AGS 4 | 117,8 | 90,5 | 38,5 | | 1" -14 UNS 2A | SAE J 1453 | PPV3.2025.532 | 644 | 10 | PPV3.2025.533 | 310 | 30 |

THREADS

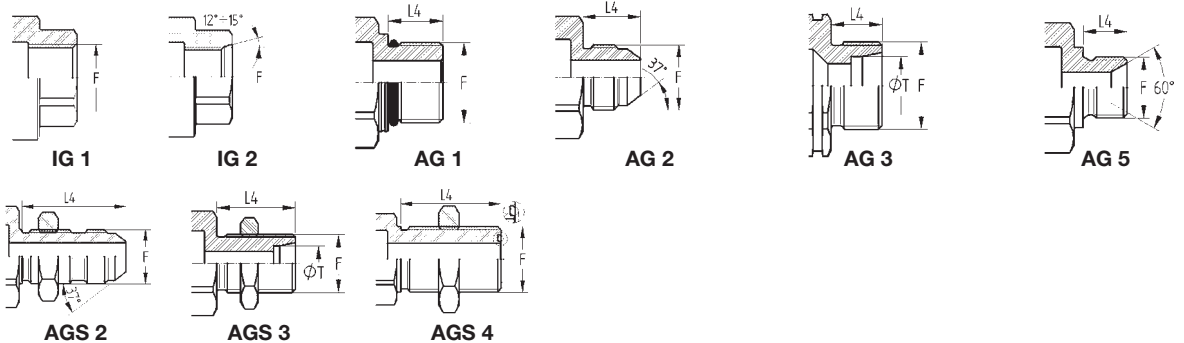

PPV3 DN25 - BG 5 - ISO 25

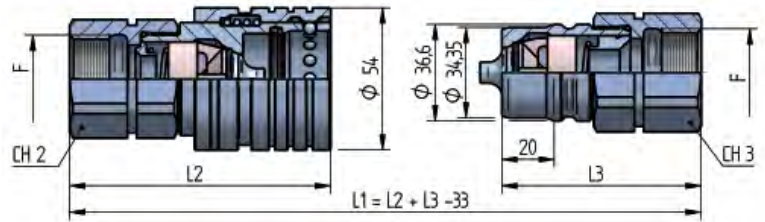

| THREADS | CH2 | L2 | CH3 | L3 | L4 | ØT | F | STANDARD | FEMMINA - FEMALE - MUFFE - FEMELLE | | | MASCHIO - MALE - STECKER - MALE | | |
|---------|-----|-------|-----|-----|----|-----|-----------------|--------------|------------------------------------|------------|--------------|---------------------------------|------------|------------------|
| | | | | | | | | | COD. F | Weight (g) | Pack. (pcs.) | COD. M | Weight (g) | Packaging (pcs.) |
| IG 1 | 41 | 99,5 | 41 | 76 | | | BSP 3/4" | DIN 3852-2-X | PPV3.2519.112 | 870 | 18 | PPV3.2519.113 | 453 | 30 |
| | 41 | 99,5 | 41 | 76 | | | NPT 3/4" | ANSI B1.20.3 | PPV3.2519.012 | 877 | 18 | PPV3.2519.013 | 460 | 30 |
| | 41 | 99,5 | 41 | 76 | | | BSP 1" | DIN 3852-2-X | PPV3.2525.112 | 815 | 18 | PPV3.2525.113 | 398 | 30 |
| | 41 | 99,5 | 41 | 76 | | | NPT 1" | ANSI B1.20.3 | PPV3.2525.012 | 827 | 18 | PPV3.2525.013 | 411 | 30 |
| | 41 | 99,5 | 41 | 76 | | | M30x1,5 | ISO 6149-1 | PPV3.2530.102 | 842 | 18 | PPV3.2530.103 | 426 | 30 |
| IG 2 | 41 | 99,5 | 41 | 76 | | | 1"1/16-16 UN 2B | SAE J 1926-1 | PPV3.2527.032 | 863 | 18 | PPV3.2527.033 | 447 | 30 |
| | 41 | 99,5 | 41 | 76 | | | 1"5/16-12 UN 2B | SAE J 1926-1 | PPV3.2533.032 | 842 | 18 | PPV3.2533.033 | 389 | 30 |
| AG 5 | 41 | 101,5 | 41 | 78 | 18 | | BSP 1" | DIN 3852-2-B | PPV3.2525.212 | 814 | 18 | PPV3.2525.213 | 398 | 30 |
| | 41 | 97,5 | 41 | 74 | 17 | | BSP 1" | BS B5200 | PPV3.2525.702 | 790 | 18 | PPV3.2525.703 | 373 | 30 |
| | 41 | 99,5 | 41 | 76 | 16 | | BSP 3/4" | DIN 3852-2-A | PPV3.2519.712 | 788 | 18 | PPV3.2519.713 | 372 | 30 |
| | 41 | 101,5 | 41 | 78 | 18 | | BSP 1" | DIN 3852-2-A | PPV3.2525.712 | 814 | 18 | PPV3.2525.713 | 398 | 30 |
| AG 3 | 41 | 92,5 | 41 | 69 | 12 | 18L | M26x1,5 | ISO 8434-1-L | PPV3.2526.302 | 765 | 18 | PPV3.2526.303 | 348 | 30 |
| | 41 | 94,5 | 41 | 71 | 14 | 22L | M30x2 | ISO 8434-1-L | PPV3.2530.302 | 770 | 18 | PPV3.2530.303 | 353 | 30 |
| | 41 | 94,5 | 41 | 71 | 14 | 28L | M36x2 | ISO 8434-1-L | PPV3.2536.302 | 775 | 18 | PPV3.2536.303 | 359 | 30 |
| | 46 | 96,5 | 46 | 73 | 16 | 35L | M45x2 | ISO 8434-1-L | PPV3.2545.302 | 863 | 18 | PPV3.2545.303 | 447 | 30 |
| | 41 | 96,5 | 41 | 73 | 16 | 20S | M30x2 | ISO 8434-1-S | PPV3.2530.402 | 781 | 18 | PPV3.2530.403 | 364 | 30 |
| | 41 | 98,5 | 41 | 75 | 18 | 25S | M36x2 | ISO 8434-1-S | PPV3.2536.402 | 803 | 18 | PPV3.2536.403 | 387 | 30 |
| | 46 | 100,5 | 46 | 77 | 20 | 30S | M42x2 | ISO 8434-1-S | PPV3.2542.402 | 884 | 10 | PPV3.2542.403 | 468 | 25 |
| | 55 | 102,5 | 55 | 79 | 22 | 38S | M52x2 | ISO 8434-1-S | PPV3.2552.402 | 1072 | 10 | PPV3.2552.403 | 655 | 25 |
| AGS 3 | 41 | 114,5 | 41 | 91 | 34 | 18L | M26x1,5 | ISO 8434-1-L | PPV3.2526.502 | 817 | 10 | PPV3.2526.503 | 436 | 25 |
| | 41 | 114,5 | 41 | 91 | 34 | 22L | M30x2 | ISO 8434-1-L | PPV3.2530.502 | 831 | 10 | PPV3.2530.503 | 462 | 25 |
| | 41 | 114,5 | 41 | 91 | 34 | 28L | M36x2 | ISO 8434-1-L | PPV3.2536.502 | 858 | 10 | PPV3.2536.503 | 499 | 25 |
| | 46 | 120,5 | 46 | 97 | 40 | 35L | M45x2 | ISO 8434-1-L | PPV3.2545.502 | 1049 | 10 | PPV3.2545.503 | 714 | 25 |
| | 41 | 116,5 | 41 | 93 | 36 | 20S | M30x2 | ISO 8434-1-S | PPV3.2530.602 | 848 | 10 | PPV3.2530.603 | 479 | 25 |
| | 41 | 118,5 | 41 | 95 | 38 | 25S | M36x2 | ISO 8434-1-S | PPV3.2536.602 | 898 | 10 | PPV3.2536.603 | 540 | 25 |
| | 46 | 120,5 | 46 | 97 | 40 | 30S | M42x2 | ISO 8434-1-S | PPV3.2542.602 | 1003 | 10 | PPV3.2542.603 | 650 | 20 |
| | 55 | 133,5 | 55 | 110 | 53 | 38S | M52x2 | ISO 8434-1-S | PPV3.2552.602 | 1366 | 10 | PPV3.2552.603 | 949 | 20 |

THREADS

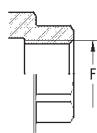

IG 1

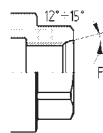

IG 2

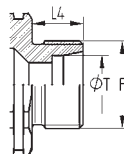

AG 3

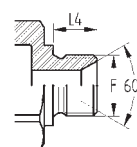

AG 5

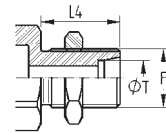

AGS 3

PLASTIC

| NOMINAL SIZE | | | FEMALE DUST PLUG | | | MALE DUST CAP | | | COLOUR | MATERIAL |
|--------------|----|------|------------------|------------|------------------|---------------|------------|------------------|--------|--------------|
| DNP | BG | ISO | COD. F | Weight (g) | Packaging (pcs.) | COD. M | Weight (g) | Packaging (pcs.) | | |
| 06 | 1 | 6.3 | SPAV.06002 | 4 | 200 | SPAV.06003 | 4 | 150 | RED | Polyethylene |
| 10 | 2 | 10 | SPAV.10002 | 14 | 100 | SPAV.10003 | 16 | 100 | RED | PVC |
| 13 | 3 | 12.5 | SPAV.13002 | 20 | 50 | SPAV.13003 | 21 | 50 | RED | PVC |
| 13 | 3 | 12.5 | SPAV.13012 | 20 | 50 | SPAV.13013 | 21 | 50 | YELLOW | PVC |
| 13 | 3 | 12.5 | SPAV.13022 | 20 | 50 | SPAV.13023 | 21 | 50 | GREEN | PVC |
| 13 | 3 | 12.5 | SPAV.13032 | 20 | 50 | SPAV.13033 | 21 | 50 | BLUE | PVC |
| 13 | 3 | 12.5 | SPAV.13042 | 20 | 50 | SPAV.13043 | 21 | 50 | BLACK | PVC |
| 13 | 3 | 12.5 | SPAV.13052 | 20 | 50 | SPAV.13053 | 21 | 50 | WHITE | PVC |
| 20 | 4 | 19 | SPAV.20002 | 33 | 50 | SPAV.20003 | 39 | 25 | RED | PVC |
| 25 | 5 | 25 | SPAV.25002 | 16 | 50 | SPAV.25003 | 19 | 25 | RED | Polyethylene |

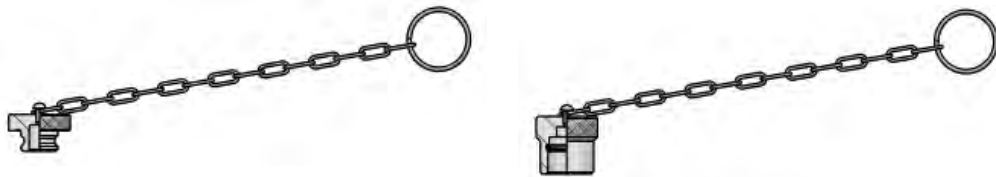
METAL

| NOMINAL SIZE | | | FEMALE DUST PLUG | | | MALE DUST CAP | | | COLOUR | MATERIAL |
|--------------|----|------|------------------|------------|------------------|---------------|------------|------------------|--------|-----------|
| DNP | BG | ISO | COD. F | Weight (g) | Packaging (pcs.) | COD. M | Weight (g) | Packaging (pcs.) | | |
| 06 | 1 | 6.3 | SPAV.06202* | 33 | 100 | SPAV.06203* | 35 | 100 | - | Aluminium |
| 10 | 2 | 10 | SPAV.10202 | 42 | 80 | SPAV.10203 | 50 | 80 | - | Aluminium |
| 13 | 3 | 12.5 | SPAV.13202 | 51 | 50 | SPAV.13203 | 70 | 50 | - | Aluminium |
| 20 | 4 | 19 | SPAV.20202 | 66 | 25 | SPAV.20203 | 107 | 25 | - | Aluminium |
| 25 | 5 | 25 | SPAV.25202* | 88 | 20 | SPAV.25203* | 160 | 20 | - | Aluminium |

* REALIZZATI SU RICHIESTA DEL CLIENTE - AVAILABLE ON REQUEST - AUF ANFRAGE LIEFERBAR - DISPONIBLES SUR DEMANDE

AUTOMATIC

| NOMINAL SIZE | | | AUTOMATIC FEMALE CAP | | | AUTOMATIC MALE CAP | | | COLOUR | MATERIAL |
|--------------|----|------|----------------------|------------|------------------|--------------------|------------|------------------|--------|----------|
| DNP | BG | ISO | COD. F | Weight (g) | Packaging (pcs.) | COD. M | Weight (g) | Packaging (pcs.) | | |
| 13 | 3 | 12.5 | SPPV.13302 | 22 | 100 | SPPV.13303 | 59 | 40 | BLACK | Nylon |
| 13 | 3 | 12.5 | SPPV.13312 | 22 | 100 | | | | YELLOW | Nylon |
| 13 | 3 | 12.5 | SPPV.13322 | 22 | 100 | | | | GREEN | Nylon |
| 13 | 3 | 12.5 | SPPV.13332 | 22 | 100 | | | | BLUE | Nylon |
| 13 | 3 | 12.5 | SPPV.13342 | 22 | 100 | SPPV.13343 | 59 | 40 | RED | Nylon |

GUARNIZIONI DI RICAMBIO / SPARE PARTS / ERSATZDICHTUNGEN / JOINTS

AL CODICE DELLA GUARNIZIONE IN NBR AGGIUNGERE 'E' PER EPDM o 'V' PER VITON

TO THE NBR GASKET CODE ADD 'E' FOR EPDM OR 'V' FOR VITON

ZU DER ARTIKELNR. DER NBR DICHTUNG GEBEN SIE 'E' FUER EPDM ODER 'V' FUER VITON AN

AU CODE DU JOINT EN NBR JOINDRE 'E' POUR EPDM OU 'V' POUR VITON

| NOMINAL SIZE | | | FEMALE GASKET | |
|--------------|----|------|---------------|-------------|
| DNP | BG | ISO | NBR | PTFE |
| 06 | 1 | 6.3 | PAV.006.120 | PAV.006.130 |
| 10 | 2 | 10 | PPV.010.120 | PPV.010.130 |
| 13 | 3 | 12.5 | PPV.013.120 | PPV.013.130 |
| 20 | 4 | 19 | PAV.019.120 | PAV.019.130 |
| 25 | 5 | 25 | PAV.025.120 | PAV.025.130 |