

NEW!

# Industrial Quick Connect Couplings

## Series ESI straight-through

**DN 7.8**

Plug Profile (original size)

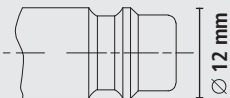

Also in Stainless Steel  
Series ESIE  
Page 303

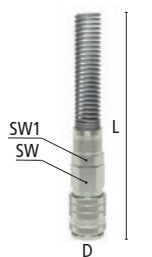
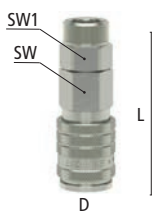
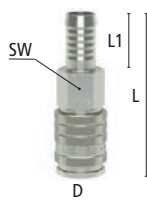

- Top-quality, extreme robust one-hand quick connect couplings with high-class sealing made of brass MS 58 nickel-plated
- Straight-through passage for optimised flow capacity, particularly for water/ liquid applications
- Please connect with plug series ESI DN 7.8 with straight-through passage (page 55)
- Collar version: protection for valve body
- High flow rates with low pressure drop due to patented OptiFlow by **LUDECKE**® valve technology
- Suitable for low vacuum at low couple force compared to all other compatible products
- For compressed air supply in industry and handcrafts, we recommend direct use at tool
- Also interchangeable with plug profile ES DN 7.2

### Materials

- Body, valve body: Brass MS 58 nickel-plated
- Valve: Brass MS 58 plain
- Sleeve, plug: Hardened steel nickel-plated
- Seals: NBR (other materials on request)
- Springs: Stainless steel 1.4310
- Balls: Stainless steel 1.4034

Max. Working Pressure	Temperature	DN	Thread	Flow Rate	Operation	Type of valve	Media	Area	
PN 35 bar	-20°C – +100°C	7,8	ISO 228/DIN EN 10226	2800 l/min	One-hand	Straight-through	Air/Others	Europe	Coupl. 5 / Plug 10

### Couplings with tapered male thread (thread coated)

Thread connection	L	SW	D	L1	Weight	Type No.
R 1/4 m	60	19	24	11	98	ESI 14 AO
R 3/8 m	61	19	24	12	97	ESI 38 AO
R 1/2 m	64	22	24	15	114	ESI 12 AO

### Couplings with parallel female thread

Thread connection	L	SW	D	L1	Weight	Type No.
G 1/4 f	56	19	24	10	116	ESI 14 IO
G 3/8 f	56	19	24	10	107	ESI 38 IO
G 1/2 f	58	24	24	12	125	ESI 12 IO

### Couplings with hose barb

Hose connection	L	SW	D	L1	Weight	Type No.
Hose i.D. 6	73	19	24	25	95	ESI 6 TO
Hose i.D. 8	73	19	24	25	97	ESI 8 TO
Hose i.D. 9	73	19	24	25	98	ESI 9 TO
Hose i.D. 10	73	19	24	25	97	ESI 10 TO
Hose i.D. 13	73	19	24	25	101	ESI 13 TO

For hose clips type ZOS (☉ page 130), type HS (☉ page 131) or crimping ferrules type LPH (☉ page 133)

### Couplings with squeeze nut

Hose connection	L	SW	D	SW1	Weight	Type No.
Hose 5x8	64	19	24	14	110	ESI 58 TQO
Hose 6x8	64	19	24	14	110	ESI 6 TQO
Hose 6.5x10	69	19	24	17	126	ESI 6510 TQO
Hose 8x10	69	19	24	19	134	ESI 8 TQO
Hose 8x12	68	19	24	19	129	ESI 812 TQO
Hose 9x13	70	19	24	19	130	ESI 913 TQO

### Couplings with squeeze nut and spring guard

Hose connection	L	SW	D	SW1	Weight	Type No.
Hose 5x8	150	19	24	14	124	ESI 58 TQFO
Hose 6x8	150	19	24	14	123	ESI 6 TQFO
Hose 6.5x10	170	19	24	17	152	ESI 6510 TQFO
Hose 8x10	170	19	24	19	162	ESI 8 TQFO
Hose 8x12	144	19	24	19	156	ESI 812 TQFO
Hose 9x13	170	19	24	19	162	ESI 913 TQFO

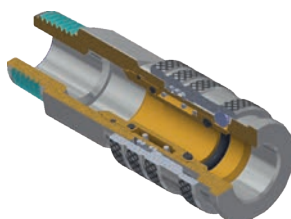

**OptiFlow**  
by **LUDECKE**

