

Quick Connect Couplings

single shut-off **Series ESA**

DN 5.5

Plug Profile (original size)

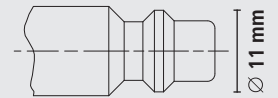

Plugs with male thread

Thread connection	L	SW	L1	L2	Material	Weight	Type No.
G 1/8 m	35	13	7	24	MS 58	19	ESA 18 NAR
G 1/4 m	37	17	9	24	MS 58	23	ESA 14 NAR
G 3/8 m	38	19	9	24	MS 58	31	ESA 38 NAR
NPT 1/8 m	38	13	9.5	24	MS 58	23	ESA 18 NA
NPT 1/4 m	41	14	13	24	MS 58	25	ESA 14 NA
NPT 3/8 m	42	17	13	24	MS 58	31	ESA 38 NA
NPT 1/4 m	41	14	13	24	Steel	22	ESA 14 NAS

Male thread sealing with PVC sealing ring type HPD (© Page 212)

Plugs with female thread

Thread connection	L	SW	L1	L2	Material	Weight	Type No.
G 1/8 f	35	13	9	24	MS 58	18	ESA 18 NIR
G 1/4 f	38	17	12	24	MS 58	27	ESA 14 NIR
G 3/8 f	39	19	12	24	MS 58	26	ESA 38 NIR
NPT 1/8 f	35	13	10	24	MS 58	20	ESA 18 NI
NPT 1/4 f	40	17	14	24	MS 58	29	ESA 14 NI
NPT 3/8 f	42	21	15	24	MS 58	40	ESA 38 NI
NPT 1/4 f	40	17	14	24	Steel	27	ESA 14 NIS

Plugs with hose barb

Hose connection	L	D	L1	L2	Material	Weight	Type No.
Hose i.D. 6	49	12	25	24	MS 58	17	ESA 6 S
Hose i.D. 9	48	12	24	24	MS 58	21	ESA 9 S
Hose i.D. 13	48	15	23	24	MS 58	29	ESA 13 S
Hose i.D. 6	49	12	25	24	Steel	16	ESA 6 SS
Hose i.D. 9	48	12	24	24	Steel	19	ESA 9 SS
Hose i.D. 13	48	15	23	24	Steel	26	ESA 13 SS

For hose clips type ZOS (© page 130), type HS (© page 131) or crimping ferrules type LPH (© page 133)

Special versions on request.

